

End Caps



Technical Data

- Galvanized Steel (ASTM A653 and A924)
- Standard product is supplied in 26 GA, G-60 coating (ASTM A653 and ASTM A90)
- Available in Specialty Metals:
 - G-90 Galvanized Steel
 - Aluminum (ASTM B209 Alloy 3003 Temper H14)
 - 304 Stainless Steel (ASTM A480 2B Finish)
- Pressure Rating: Designed per SMACNA Third Edition 2005 Section 4.8 Figure 4-6 Branch Connections
- Dimensional Tolerance: $\pm 1/4"$

Product Availability

| Size (Ød) | Gauge Availability | | Quantity Carton |
|-----------|--------------------|--------|--------------------|
| | 26 Ga. | 24 Ga. | |
| 3" | Yes | - | 30 |
| 4" | Yes | Yes | 25 |
| 5" | Yes | Yes | 40 |
| 6" | Yes | Yes | 40 |
| 7" | Yes | Yes | 20 |
| 8" | Yes | Yes | 20 |
| 9" | Yes | Yes | 10 |
| 10" | Yes | Yes | 10 |
| 12" | Yes | Yes | 5 |
| 14" | Yes | Yes | 5 |
| 16" | Yes | Yes | 10 |
| 18" | Yes | Yes | 10 |
| 20" | Yes | Yes | 10 |
| 22" | ‡ | ‡ | ‡ |
| 24" | ‡ | ‡ | ‡ |

‡ Consult factory for availability.

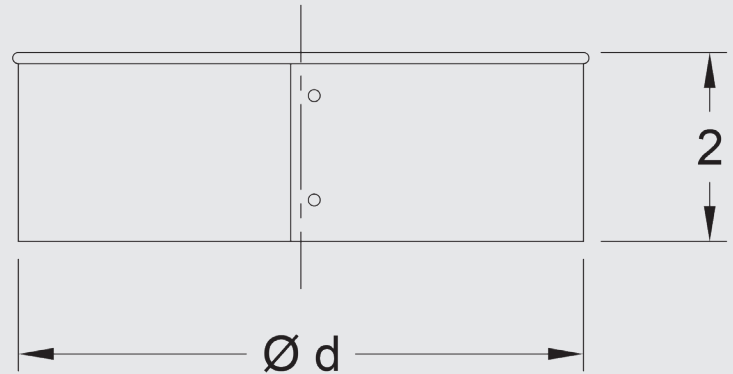

Part Number Schematic

Example: **ECC10GA26**** = End Cap with a Crimped End in 26 Ga. Galvanized Steel with Crimped Ends.

| EC | P | 10 | GA | 26 |
|---------|--|-----------------------|---|--|
| End Cap | P - Plain (Std.) C - Crimped (Opt.) | End Cap Diameter (Ød) | Material GA-Galvanized (Std.) AL - Aluminum S4 - 304 S.S | Gauge GA - 28, 26, 24 AL - 32 S4 - 26 |

** Add 90 for G90 Galvanized Coating
Items in green denote other available features
Check with your sales representative for availability of any size, gauge, or specialty metal item not shown here.